

WALL LAMP HOUSING

NR-OWLS1901-1-BK
NR-OWLS0301-2-BK
IP65

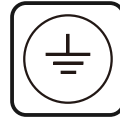

Model No	Color	Cap Type	Dimensions in mm			
			A	B	C	
NR-OWLS1901-1-BK	Black	G9*1(Max.≤12W)	100	100	100	0.38
NR-OWLS0301-2-BK	Black	G9*2(Max.≤12W/Cap)	200	100	100	0.77

Dimensions in mm

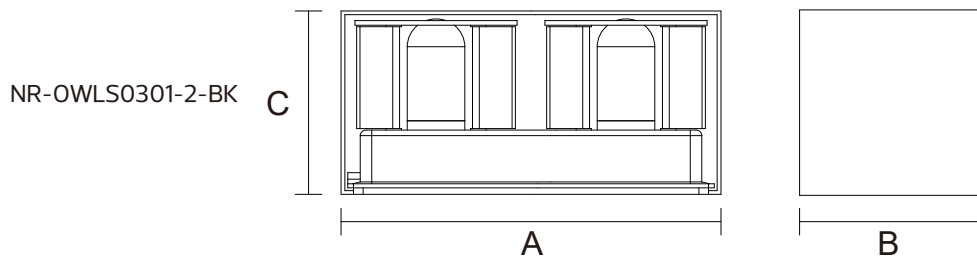
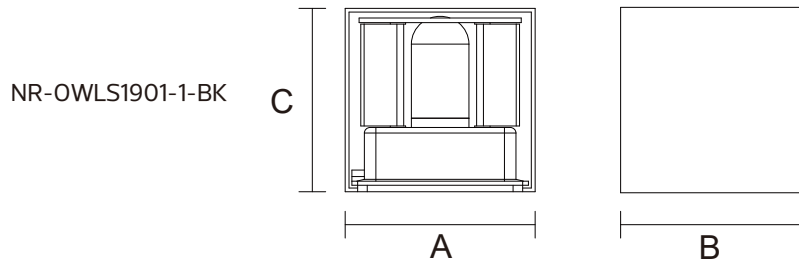

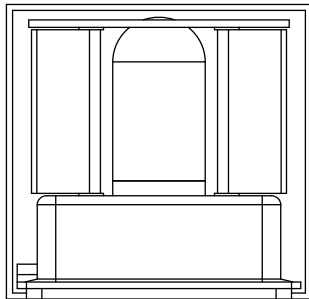
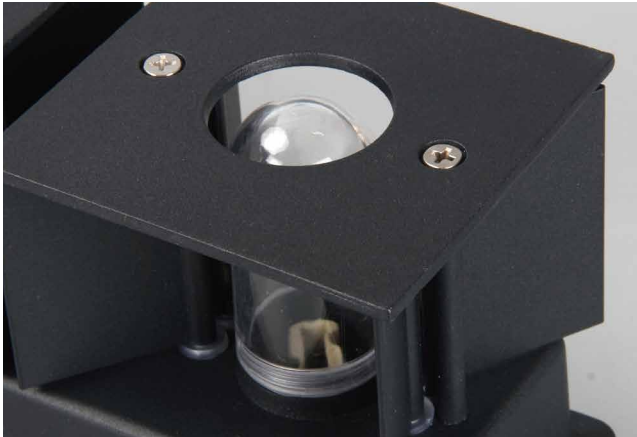

Description:
WALL LAMP HOUSING

Main material:
Aluminum+PC

Specification
Energy saving, up to 85% energy saving
comparing to standard halogen and incandescent
lamps
High quality light, high color rendering, less heat,
no UV or IR radiation
IP65

Applications
• Park
• Square
• Tourist attraction
• Corridor

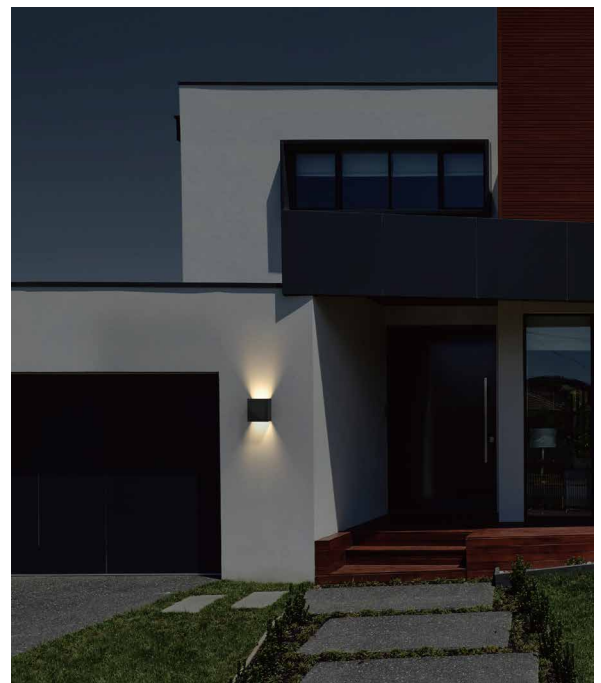
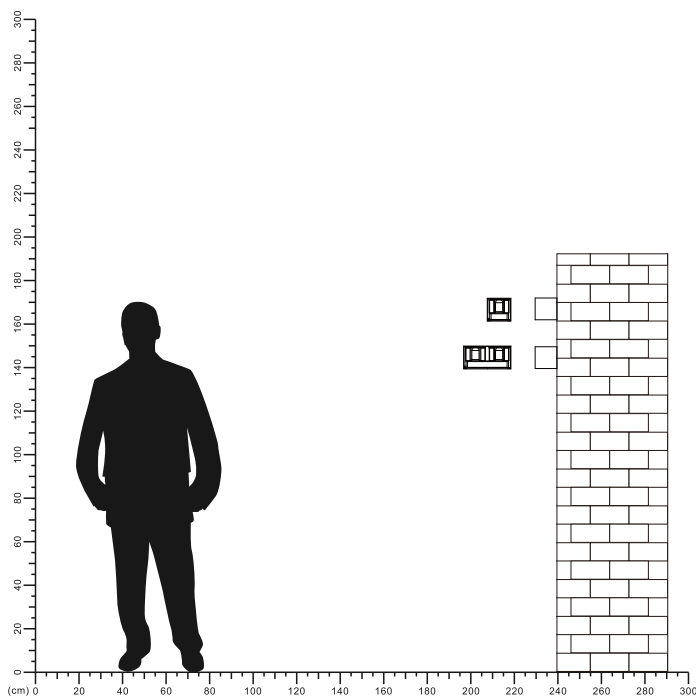

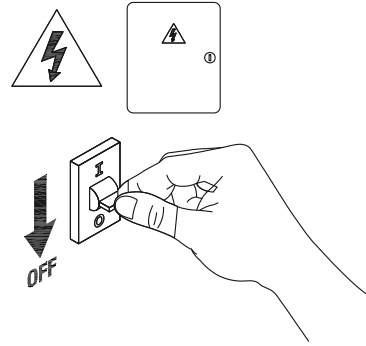
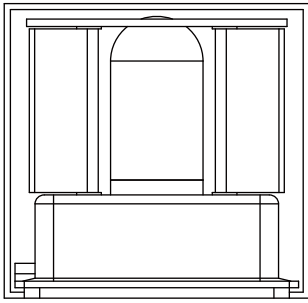

1

Turn off The Power

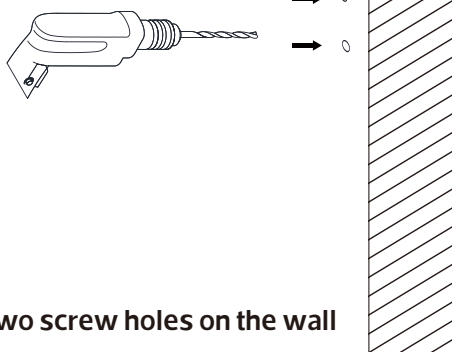

2

Drill two screw holes on the wall

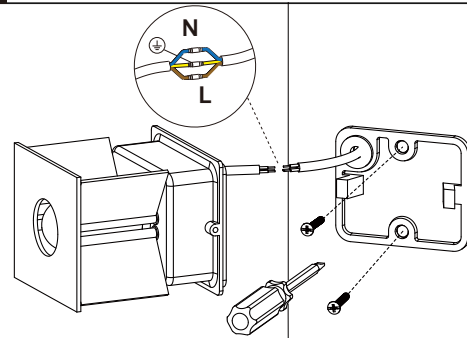

3

Install the base and connect cables

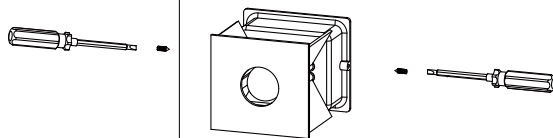

4

Fixing the body to the base.

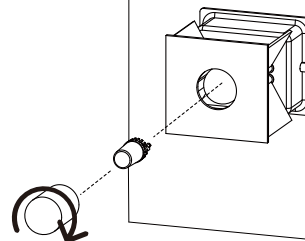

5

Install G9 LED lamp

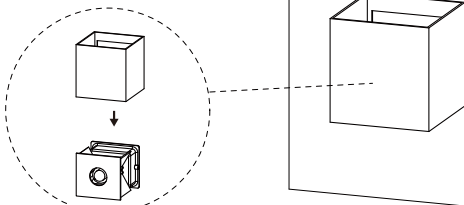

6

Install the shell and completed the installation

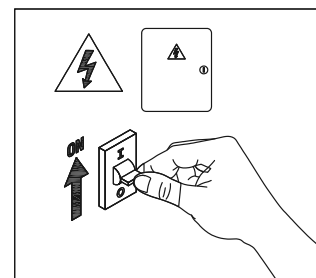

7

Turn on the power

