

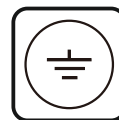

LED Ceiling Lamp

YD-1109 Series

IP20



Item Code	Cap Type	Dimensions in mm		
		A	B	
YD-1109-12	G9*12	Φ880	800	1.7
YD-1109-18	G9*18	Φ1020	800	2.2
YD-1109-24	G9*24	Φ1350	800	3.1

Dimensions in mm

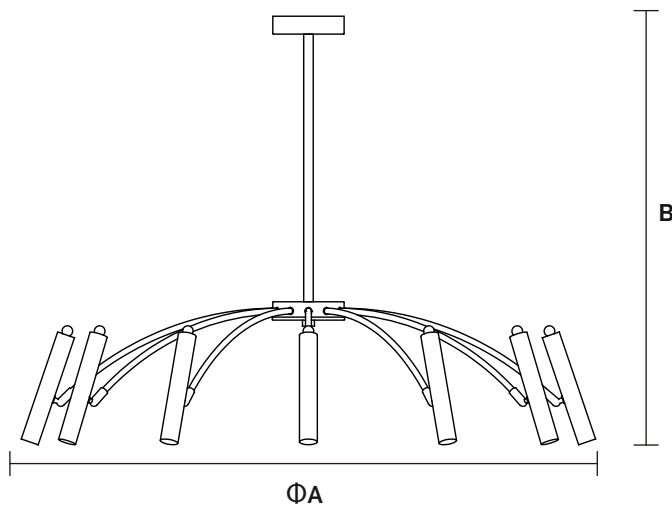

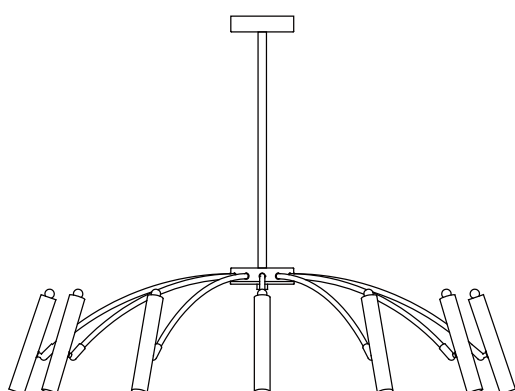

Description:
LED Ceiling Lamp

Main material:
Stainless steel

Specification

Special tree branch shape appearance, simple but full of personality and creative, randomly match the scene.
IP20

Applications

- . Hotel
- . Drawing room
- . Corridor

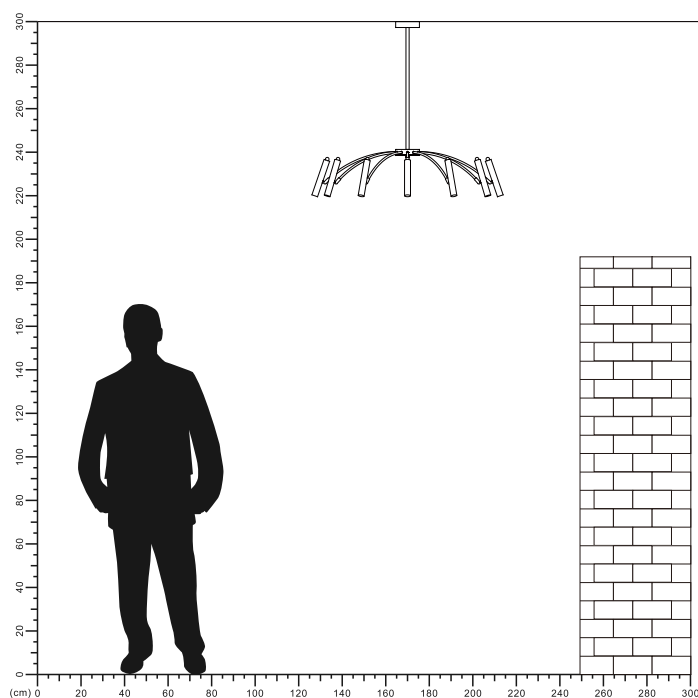

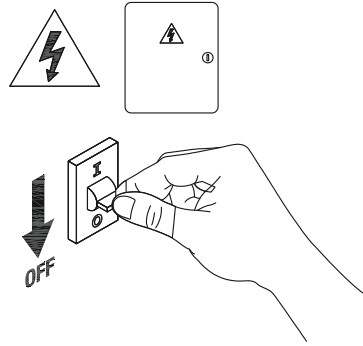
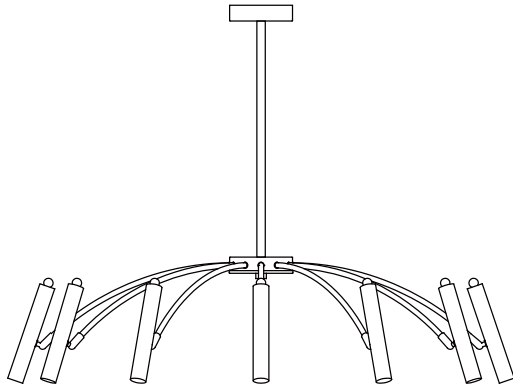

1

Turn off The Power



2

Drill 2 holes on your ceiling

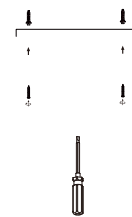

3

Install base plate

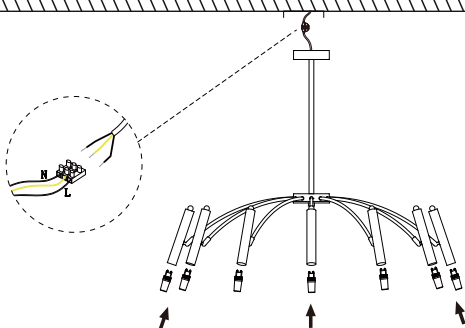

4

Install the G9 bulb and connect the power supply

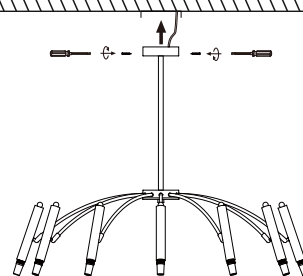

5

Install the ceiling lamp on the base plate

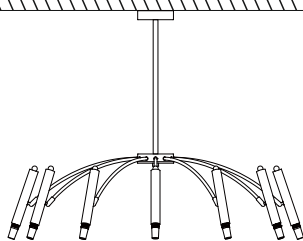

6

Installation completed

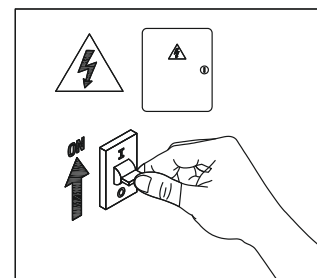

7

Turn on the power

