

LED Ceiling Lamp

YD-8016 Series

IP20

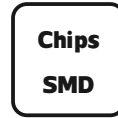
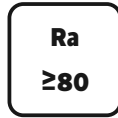

Item Code	P (W)	CCT (K)	Dimensions in mm		kg
			A	B	
YD-8016-60	30W	3000K	Φ600	1100	1.6
YD-8016-80	40W	3000K	Φ800	1100	1.78
YD-8016-120	60W	3000K	Φ1200	1100	2.83

Dimensions in mm

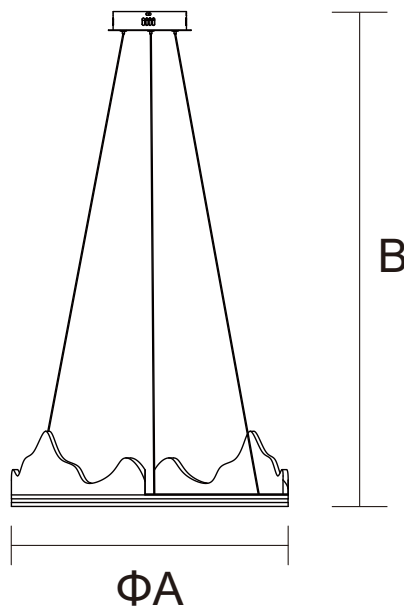

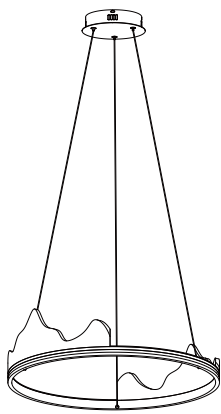
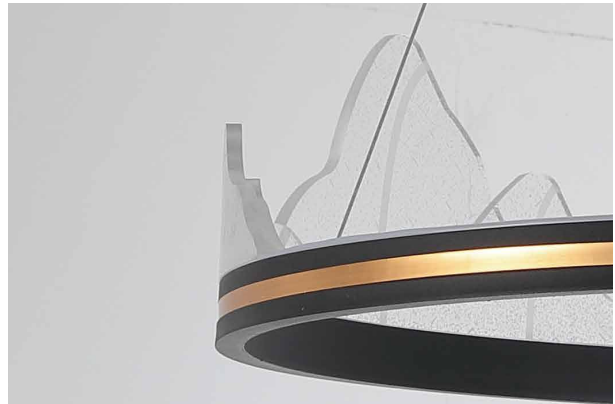

Description:
LED Ceiling Lamp

Main material:
Acrylic+Aluminum

Specification

Special tree branch shape appearance, simple but full of personality and creative, randomly match the scene.
IP20

Applications

- . Hotel
- . Drawing room
- . Corridor

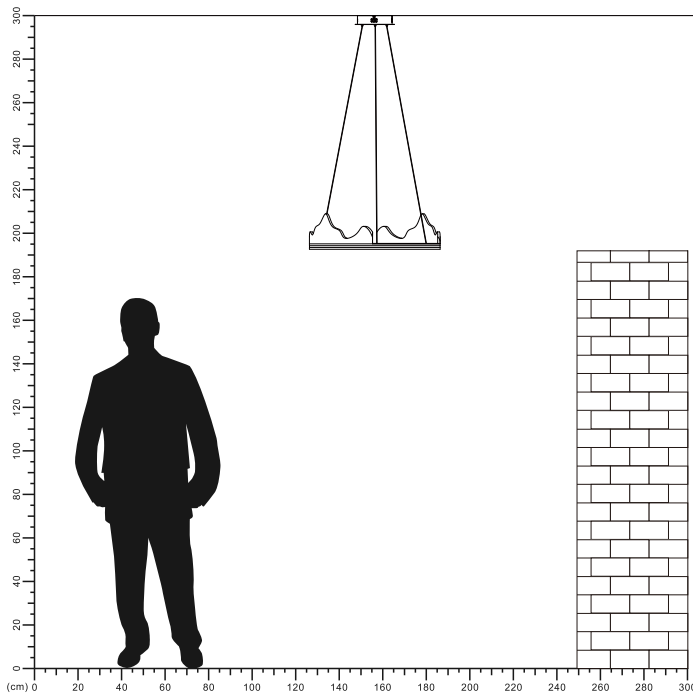

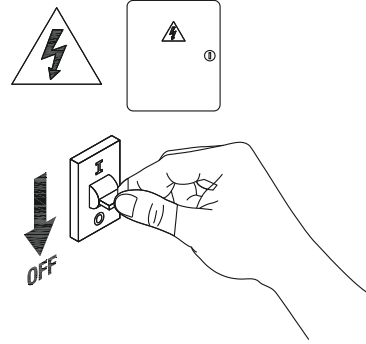
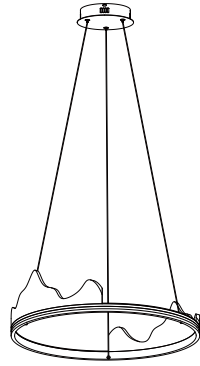

1

Turn off The Power

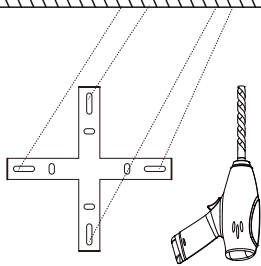

2

Drill 4 holes in the ceiling according to the size of the base plate

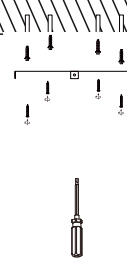

3

Install base plate

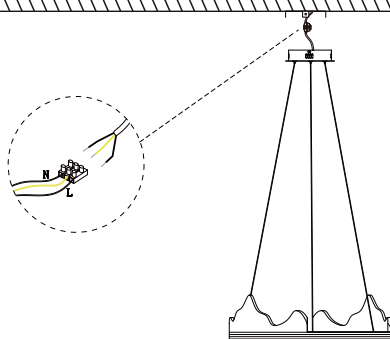

4

connect the cable

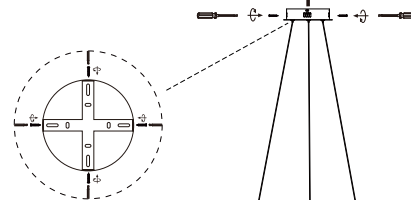

5

Install the ceiling lamp on the base plate

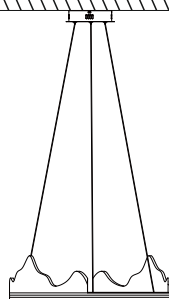

6

Installation completed

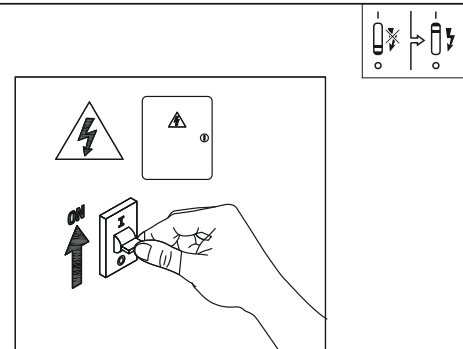

7

Turn on the power

